

EXISTING LEGAL DESCRIPTIONS

LOT 1
 THAT PORTION OF THE SOUTHWEST QUARTER OF THE SOUTHWEST QUARTER OF SECTION 8, TOWNSHIP 20 NORTH, RANGE 15 EAST, W.M., KITTITAS COUNTY, WASHINGTON, MORE PARTICULARLY DESCRIBED AS FOLLOWS;
 LOT 1 OF THAT CERTAIN TAX LOT SEGREGATION SURVEY AS FILED IN BOOK 23 OF SURVEYS ON PAGE 84 AND RECORDED UNDER RECORDERS CERTIFICATE NUMBER 199803060013, RECORDS OF KITTITAS COUNTY, WASHINGTON.

LOT 2
 THAT PORTION OF THE SOUTH HALF OF THE SOUTHWEST QUARTER OF SECTION 8, TOWNSHIP 20 NORTH, RANGE 15 EAST, W.M., KITTITAS COUNTY, WASHINGTON, MORE PARTICULARLY DESCRIBED AS FOLLOWS;
 LOT 2 OF THAT CERTAIN TAX LOT SEGREGATION SURVEY AS FILED IN BOOK 23 OF SURVEYS ON PAGE 84 AND RECORDED UNDER RECORDERS CERTIFICATE NUMBER 199803060013, RECORDS OF KITTITAS COUNTY, WASHINGTON.

LOT 3
 THAT PORTION OF THE SOUTHWEST QUARTER OF THE SOUTHWEST QUARTER OF SECTION 8, TOWNSHIP 20 NORTH, RANGE 15 EAST, W.M., KITTITAS COUNTY, WASHINGTON, MORE PARTICULARLY DESCRIBED AS FOLLOWS;
 LOT 3 OF THAT CERTAIN TAX LOT SEGREGATION SURVEY AS FILED IN BOOK 23 OF SURVEYS ON PAGE 84 AND RECORDED UNDER RECORDERS CERTIFICATE NUMBER 199803060013, RECORDS OF KITTITAS COUNTY, WASHINGTON.

LOT 4
 THAT PORTION OF THE NORTH HALF, THE SOUTHWEST QUARTER AND THE NORTH HALF OF THE SOUTHWEST QUARTER OF SECTION 8, TOWNSHIP 20 NORTH, RANGE 15 EAST, W.M., KITTITAS COUNTY, WASHINGTON, MORE PARTICULARLY DESCRIBED AS FOLLOWS:
 LOT 4 OF THAT CERTAIN TAX LOT SEGREGATION SURVEY AS FILED IN BOOK 23 OF SURVEYS ON PAGE 84 AND RECORDED UNDER RECORDERS CERTIFICATE NUMBER 199803060013, RECORDS OF KITTITAS COUNTY, WASHINGTON.

- SURVEY NOTES:**
- ALL BEARINGS AND DISTANCES ARE WASHINGTON STATE PLANE COORDINATE GRID VALUES (SOUTH ZONE - NAD 83/91) BASED ON THE KITTITAS COUNTY GPS NETWORK, USC&GS MONUMENTS AND USFS - WENATCHEE NATIONAL FOREST GPS MONUMENTS. THE COMBINED FACTOR USED FOR THIS PROJECT IS 0.9998681.
 - THE CONTROL SURVEY WAS PERFORMED IN OCTOBER, 1996 AND MAY THROUGH NOVEMBER, 1997 WITH A THREE SECOND TOTAL STATION. CORNER TIES AND ADDITIONAL CONTROL WAS RUN IN JULY THROUGH NOVEMBER, 1997 USING STATIC & REAL TIME KINEMATIC GPS METHODS BASED ON THE KITTITAS COUNTY CONTROL NETWORK IN CONJUNCTION WITH THE PREVIOUSLY ESTABLISHED NETWORK SET BY EASTSIDE CONSULTANTS. ALL TRAVERSES EXCEEDED THE MINIMUM ACCURACY STANDARDS AS SET FORTH BY WAC 332-130.
 - THE PURPOSE OF THIS SURVEY IS TO IDENTIFY THE EXTERIOR BOUNDARIES OF THE PARCELS AS DESCRIBED AND TO THEN ADJUST THESE BOUNDARIES TO THE CONFIGURATION AS SHOWN HEREON.
 - IT IS NOT THE INTENT OF THIS SURVEY TO SHOW EASEMENTS OF RECORD OR OTHERWISE.
 - THIS SURVEY IS BASED ON THAT TAX LOT SEGREGATION SURVEY AS FILED IN BOOK 23 OF SURVEYS ON PAGE 84, RECORDS OF KITTITAS COUNTY, WASHINGTON.

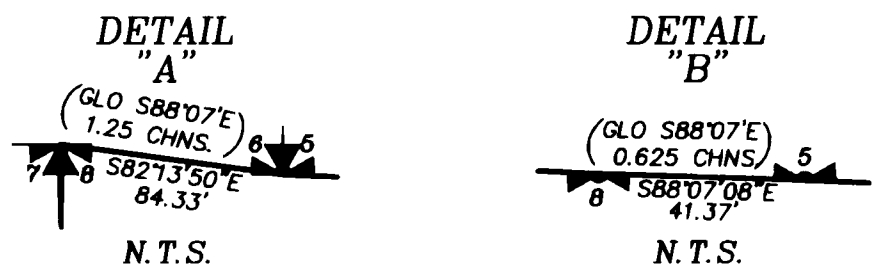
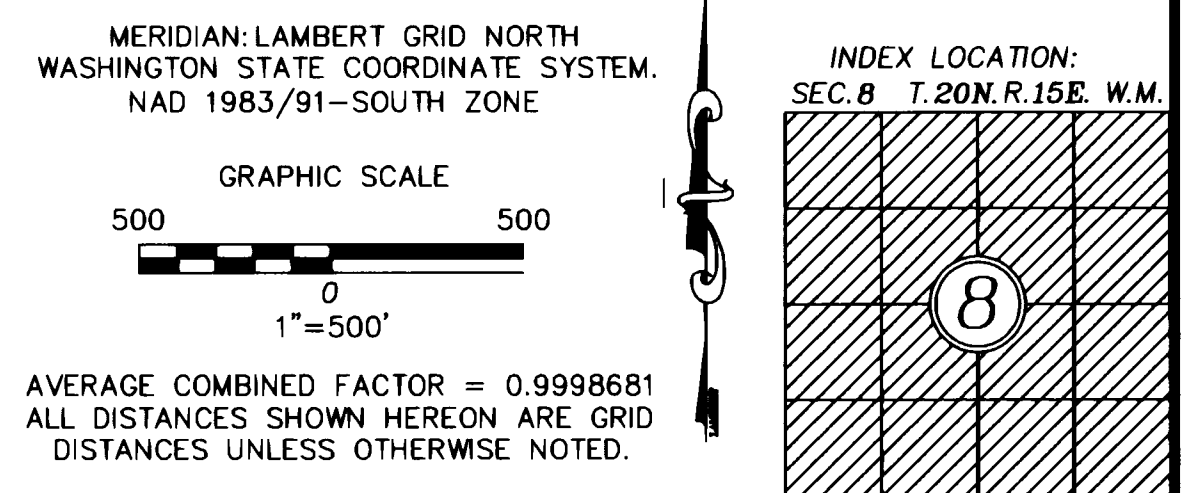
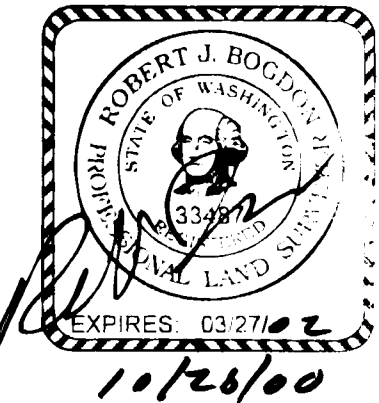

- LEGEND**
- SECTION CORNER
 - QUARTER CORNER
 - FOUND MONUMENT (DESC)
 - SET REBAR WITH L.S. CAP No. 16915.

RECORDER'S CERTIFICATE 200011020015...

Filed for record this 2nd day of Nov. 2000 at 5:00 P.M. in book 25 of Surveys at page 146 at the request of ROBERT J. BOGDON, Surveyor's Name.

Mgr. *Abbas* Supt. of Records

SURVEYOR'S CERTIFICATE

This map correctly represents a survey made by me or under my direction in conformance with the requirements of the Survey Recording Act at the request of PLUM CREEK TIMBER COMPANY in SEP. 2000.

ROBERT J. BOGDON
 Certificate No. 33487

EASTSIDE CONSULTANTS, INC.

ENGINEERS-SURVEYORS
 516 EAST FIRST
 CLE ELUM, WA 98922

PHONE: (509)674-7433
 FAX: (509)674-7419

BOUNDARY LINE ADJUSTMENT
 PREPARED FOR
PLUM CREEK TIMBER COMPANY

KITTITAS COUNTY		WASHINGTON	
DWN BY	DATE	JOB NO.	
G. WEISER	9/00	00589	
CHKD BY	SCALE	SHEET	
R. BOGDON	1"=500'	1 OF 1	